

| SHEET HOJA | DESCRIPTION DESCRIPCIÓN |
|------------|---|
| 2-3 | COMPONENT DESIGNATION DENOMINACIÓN DE LOS COMPONENTES |
| 4 | CONTROL CONNECTIONS CONEXIONES DE CONTROL |
| 5 | POWER SUPPLY SUMINISTRO EL CTICO |
| 6 | POWER AND CONTROL CIRCUIT COMPRESSOR 1 CIRCUIT A CIRCUITOS DE CONTROL Y POTENCIA DEL COMPRESOR 1, CIRCUITO A |
| 7 | POWER AND CONTROL CIRCUIT COMPRESSOR 1 CIRCUIT B CIRCUITOS DE CONTROL Y POTENCIA DEL COMPRESOR 1, CIRCUITO B |
| 8 | CONTROL WIRING CONTROL |
| 9 | CONTROL WIRING CONTROL |
| 10 | CONDENSER FAN POWER AND CONTROL CIRCUIT A CIRCUITOS DE CONTROL Y ALIMENTACIÓN EL CTICA DEL VENTILADOR DEL CONDENSADOR, CIRCUITO A |
| 11 | CONDENSER FAN POWER AND CONTROL CIRCUIT B CIRCUITOS DE CONTROL Y ALIMENTACIÓN EL CTICA DEL VENTILADOR DEL CONDENSADOR, CIRCUITO B |
| 12 | CONTROL WIRING CONTROL |
| 13 | TERMINAL BLOCK AND NOTES BLOQUE DE TERMINALES Y NOTAS |
| 14 | SITING UBICACIÓN |
| 15 | SITING UBICACIÓN |
| 16 | SITING UBICACIÓN |



WIRING DIAGRAM ESQUEMA EL ECTRICO

UNIT TYPE 30XA0502-A0367-PE-
TIPO DE UNIDAD
ORDER NUMBER 0000783208 / 000010
NUMERO DE PEDIDO

| OPT_NR NO OPTION | DESCRIPTION DESCRIPCION |
|---------------------|---------------------------------|
| OPT_017 | VARIABLE SPEED FANS ? |
| OPT_149 | SAIA + Bacnet Display BACNET |

| IND | MODIF NR | NAME | DATE |
|-----|----------|------|------|
| | | | |

| NAME NOMBRE | CARRIER | DATE FECHA | SHEET HOJA |
|----------------|---------|---------------|---------------|
| | | 25/01/2018 | 1 |
| 00DCG008204800 | | | A |

| | | | |
|---------|---|---------|--|
| A1A | INPUT/OUTPUT MODULE, CIRCUIT A | A1A | MÓDULO DE ENTRADAS/SALIDAS, CIRCUITO A |
| A1C | COMPRESSOR 1 MONITORING, CONTROL AND SAFETY MODULE, CIRCUIT A | A1C | MÓDULO DE MONITORIZACIÓN, CONTROL Y SEGURIDAD DEL COMPRESOR 1, CIRCUITO DE REFRIGERACIÓN A |
| A2 | DISPLAY | A2 | PANTALLA |
| A2A | INPUT/OUTPUT MODULE, CIRCUIT B | A2A | MÓDULO DE ENTRADAS/SALIDAS, CIRCUITO B |
| A2C | COMPRESSOR 1 MONITORING, CONTROL AND SAFETY MODULE, CIRCUIT B | A2C | MÓDULO DE MONITORIZACIÓN, CONTROL Y SEGURIDAD DEL COMPRESOR 1, CIRCUITO DE REFRIGERACIÓN B |
| BP1 | DISCHARGE PRESSURE TRANSDUCER, CIRCUIT A | BP1 | TRANSDUCTOR DE PRESIÓN DE DESCARGA, CIRCUITO A |
| BP2 | DISCHARGE PRESSURE TRANSDUCER, CIRCUIT B | BP2 | TRANSDUCTOR DE PRESIÓN DE DESCARGA, CIRCUITO B |
| BP3 | SUCTION PRESSURE TRANSDUCER. CIRCUIT A | BP3 | TRANSDUCTOR DE PRESIÓN DE ASPIRACIÓN, CIRCUITO DE REFRIGERACIÓN A |
| BP4 | SUCTION PRESSURE TRANSDUCER. CIRCUIT B | BP4 | TRANSDUCTOR DE PRESIÓN DE ASPIRACIÓN, CIRCUITO DE REFRIGERACIÓN B |
| BP71 | OIL PRESSURE TRANSDUCER, COMPRESSOR 1, CIRCUIT A | BP71 | TRANSDUCTOR DE PRESIÓN DE ACEITE, COMPRESOR 1, CIRCUITO A |
| BP72 | OIL PRESSURE TRANSDUCER, COMPRESSOR 1, CIRCUIT B | BP72 | TRANSDUCTOR DE PRESIÓN DE ACEITE, COMPRESOR 1, CIRCUITO B |
| BP81 | ECONOMIZER PRESSURE TRANSDUCER | BP81 | TRANSDUCTOR DE PRESIÓN DEL ECONOMIZADOR |
| BP82 | ECONOMIZER PRESSURE TRANSDUCER | BP82 | TRANSDUCTOR DE PRESIÓN DEL ECONOMIZADOR |
| EC1(A1) | COMPRESSOR 1, CIRCUIT A | EC1(A1) | COMPRESOR 1, CIRCUITO A |
| EC2(B1) | COMPRESSOR 1, CIRCUIT B | EC2(B1) | COMPRESOR 1, CIRCUITO B |
| ED1 | ELECTRONIC EXPANSION VALVE, CIRCUIT A | ED1 | VÁLVULA DE EXPANSIÓN ELECTRÓNICA, CIRCUITO A |
| ED2 | ELECTRONIC EXPANSION VALVE, CIRCUIT B | ED2 | VÁLVULA DE EXPANSIÓN ELECTRÓNICA, CIRCUITO B |
| ED81 | ELECTRONIC EXPANSION VALVE ECONOMIZER, CIRCUIT A | ED81 | VÁLVULA DE EXPANSIÓN ELECTRÓNICA DEL ECONOMIZADOR, CIRCUITO A |
| ED82 | ELECTRONIC EXPANSION VALVE ECONOMIZER, CIRCUIT B | ED82 | VÁLVULA DE EXPANSIÓN ELECTRÓNICA DEL ECONOMIZADOR, CIRCUITO B |
| EF101 | ELECTRICAL BOX FAN | EF101 | VENTILADOR DEL CUADRO EL CTRICO |
| EF101A | ELECTRICAL BOX FAN | EF101A | VENTILADOR DEL CUADRO EL CTRICO |
| EH71 | OIL HEATER CIRCUIT A | EH71 | CALENTADOR DE ACEITE, CIRCUITO A |
| EH72 | OIL HEATER CIRCUIT B | EH72 | CALENTADOR DE ACEITE, CIRCUITO B |
| EV11 | CONDENSER FAN | EV11 | VENTILADOR DEL CONDENSADOR |
| EV12 | CONDENSER FAN | EV12 | VENTILADOR DEL CONDENSADOR |
| EV21 | CONDENSER FAN | EV21 | VENTILADOR DEL CONDENSADOR |
| EV31 | CONDENSER FAN | EV31 | VENTILADOR DEL CONDENSADOR |
| EV32 | CONDENSER FAN | EV32 | VENTILADOR DEL CONDENSADOR |
| EV41 | CONDENSER FAN | EV41 | VENTILADOR DEL CONDENSADOR |
| EV42 | CONDENSER FAN | EV42 | VENTILADOR DEL CONDENSADOR |
| EV51 | CONDENSER FAN | EV51 | VENTILADOR DEL CONDENSADOR |
| EV52 | CONDENSER FAN | EV52 | VENTILADOR DEL CONDENSADOR |
| FT1 | COMPRESSOR MOTOR TEMPERATURE SENSOR, COMPRESSOR 1, CIRCUIT A | FT1 | SENSOR DE TEMPERATURA DEL MOTOR DEL COMPRESOR, COMPRESOR 1, CIRCUITO A |
| FT2 | COMPRESSOR MOTOR TEMPERATURE SENSOR, COMPRESSOR 1, CIRCUIT B | FT2 | SENSOR DE TEMPERATURA DEL MOTOR DEL COMPRESOR, COMPRESOR 1, CIRCUITO B |
| GSA1 | CONDENSER FAN MOTOR VARIABLE SPEED DRIVE, CIRCUIT A | GSA1 | VARIADOR DE VELOCIDAD VARIABLE DEL MOTOR DEL VENTILADOR DEL CONDENSADOR, CIRCUITO A |
| GSA2 | CONDENSER FAN MOTOR VARIABLE SPEED DRIVE, CIRCUIT A | GSA2 | VARIADOR DE VELOCIDAD VARIABLE DEL MOTOR DEL VENTILADOR DEL CONDENSADOR, CIRCUITO A |
| GSB1 | CONDENSER FAN MOTOR VARIABLE SPEED DRIVE, CIRCUIT B | GSB1 | VARIADOR DE VELOCIDAD VARIABLE DEL MOTOR DEL VENTILADOR DEL CONDENSADOR, CIRCUITO B |
| K1 | ELECTRICAL BOX FAN RELAY | K1 | REL DEL VENTILADOR DEL CUADRO EL CTRICO |
| K71 | OIL HEATER CONTROL RELAY, CIRCUIT A | K71 | REL DE CONTROL DEL CALENTADOR DE ACEITE, CIRCUITO A |
| K72 | OIL HEATER CONTROL RELAY, CIRCUIT B | K72 | REL DE CONTROL DEL CALENTADOR DE ACEITE, CIRCUITO B |
| KM1 | CONTACTOR, COMPRESSOR 1, CIRCUIT A | KM1 | CONTACTOR, COMPRESOR 1, CIRCUITO A |
| KM1D | DELTA CONTACTOR, COMPRESSOR 1, CIRCUIT A | KM1D | CONTACTOR DE ARRANQUE EN TRIANGULO, COMPRESOR 1, CIRCUITO A |
| KM1Y | STAR CONTACTOR, COMPRESSOR 1, CIRCUIT A | KM1Y | CONTACTOR DE ARRANQUE EN ESTRELLA, COMPRESOR 1, CIRCUITO A |
| KM2 | CONTACTOR, COMPRESSOR 1, CIRCUIT B | KM2 | CONTACTOR, COMPRESOR 1, CIRCUITO B |
| KM2D | DELTA CONTACTOR, COMPRESSOR 1, CIRCUIT B | KM2D | CONTACTOR DE ARRANQUE EN TRIANGULO, COMPRESOR 1, CIRCUITO B |
| KM2Y | STAR CONTACTOR, COMPRESSOR 1, CIRCUIT B | KM2Y | CONTACTOR DE ARRANQUE EN ESTRELLA, COMPRESOR 1, CIRCUITO B |
| LEN | LEN | LEN | LEN |
| PE | GROUND | PE | TIERRA |
| QF1 | CIRCUIT BREAKER, CONTROL CIRCUIT, COMPRESSOR | QF1 | DISYUNTOR, CIRCUITO DE CONTROL, COMPRESOR |

| | | | | | |
|----------------|---------|---------------|------------|---------------|---|
| NAME NOMBRE | CARRIER | DATE FECHA | 25/01/2018 | SHEET HOJA | 2 |
| 00DCG008204800 | | | A | | |

**COMPONENT DESIGNATION
DENOMINACIÓN DE LOS COMPONENTES**

| | | | |
|--------|---|--------|---|
| QF2 | CIRCUIT BREAKER, CONTROL CIRCUIT, COMPRESSOR | QF2 | DISYUNTOR, CIRCUITO DE CONTROL, COMPRESOR |
| QMA1 | CONDENSER FAN CIRCUIT BREAKER | QMA1 | DISYUNTOR DEL VENTILADOR DEL CONDENSADOR |
| QMA2 | CONDENSER FAN CIRCUIT BREAKER | QMA2 | DISYUNTOR DEL VENTILADOR DEL CONDENSADOR |
| QMB1 | CONDENSER FAN CIRCUIT BREAKER | QMB1 | DISYUNTOR DEL VENTILADOR DEL CONDENSADOR |
| QS101 | GENERAL DISCONNECT SWITCH, CIRCUIT A | QS101 | SECCIONADOR GENERAL, CIRCUITO A |
| QS102 | GENERAL DISCONNECT SWITCH, CIRCUIT B | QS102 | SECCIONADOR GENERAL, CIRCUITO B |
| RT1 | EVAPORATOR LEAVING WATER TEMPERATURE SENSOR | RT1 | SENSOR DE TEMPERATURA DEL AGUA DE SALIDA DEL EVAPORADOR |
| RT10 | AMBIENT OR OUTSIDE AIR TEMPERATURE SENSOR | RT10 | SENSOR DE TEMPERATURA AMBIENTE O DEL AIRE EXTERIOR |
| RT2 | EVAPORATOR ENTERING WATER TEMPERATURE SENSOR | RT2 | SENSOR DE TEMPERATURA DEL AGUA DE ENTRADA DEL EVAPORADOR |
| RT31 | SUCTION TEMPERATURE SENSOR, CIRCUIT A | RT31 | SENSOR DE TEMPERATURA DE ASPIRACIÓN, CIRCUITO A |
| RT32 | SUCTION TEMPERATURE SENSOR, CIRCUIT B | RT32 | SENSOR DE TEMPERATURA DE ASPIRACIÓN, CIRCUITO B |
| RT41 | DISCHARGE GAS TEMPERATURE SENSOR, COMPRESSOR 1, CIRCUIT A | RT41 | SENSOR DE TEMPERATURA DE GAS DE DESCARGA, COMPRESOR 1, CIRCUITO A |
| RT42 | DISCHARGE GAS TEMPERATURE SENSOR, COMPRESSOR 1, CIRCUIT B | RT42 | SENSOR DE TEMPERATURA DE GAS DE DESCARGA, COMPRESOR 1, CIRCUITO B |
| RT46 | ECONOMIZER TEMPERATURE SENSOR, CIRCUIT A | RT46 | SENSOR DE TEMPERATURA DEL ECONOMIZADOR, CIRCUITO A |
| RT47 | ECONOMIZER TEMPERATURE SENSOR, CIRCUIT B | RT47 | SENSOR DE TEMPERATURA DEL ECONOMIZADOR, CIRCUITO B |
| SL71 | OIL LEVEL DETECTOR, CIRCUIT A | SL71 | DETECTOR DE NIVEL DE ACEITE, CIRCUITO A |
| SL72 | OIL LEVEL DETECTOR, CIRCUIT B | SL72 | DETECTOR DE NIVEL DE ACEITE, CIRCUITO B |
| SP1F | HIGH PRESSURE SAFETY SWITCH, COMPRESSOR 1, CIRCUIT A | SP1F | INTERRUPTOR DE SEGURIDAD DE PRESIÓN ALTA, COMPRESOR 1, CIRCUITO A |
| SP1FA | HIGH PRESSURE SAFETY SWITCH, COMPRESSOR 1, CIRCUIT A | SP1FA | INTERRUPTOR DE SEGURIDAD DE PRESIÓN ALTA, COMPRESOR 1, CIRCUITO A |
| SP2F | HIGH PRESSURE SAFETY SWITCH, COMPRESSOR 1, CIRCUIT B | SP2F | INTERRUPTOR DE SEGURIDAD DE PRESIÓN ALTA, COMPRESOR 1, CIRCUITO B |
| SP2FA | HIGH PRESSURE SAFETY SWITCH, COMPRESSOR 1, CIRCUIT B | SP2FA | INTERRUPTOR DE SEGURIDAD DE PRESIÓN ALTA, COMPRESOR 1, CIRCUITO B |
| SP90F | EVAPORATOR PUMP FLOW SWITCH | SP90F | INTERRUPTOR DE CAUDAL DE LA BOMBA DEL EVAPORADOR |
| ST101F | ELECTRICAL BOX SAFETY THERMOSTAT | ST101F | TERMOSTATO DE SEGURIDAD DEL CUADRO EL CTRICO |
| TC1 | CONTROL CIRCUIT TRANSFORMER, COMPRESSOR 1, CIRCUIT A | TC1 | TRANSFORMADOR DEL CIRCUITO DE CONTROL, COMPRESOR 1, CIRCUITO A |
| TC2 | CONTROL CIRCUIT TRANSFORMER, COMPRESSOR 1, CIRCUIT B | TC2 | TRANSFORMADOR DEL CIRCUITO DE CONTROL, COMPRESOR 1, CIRCUITO B |
| TI1 | CURRENT TRANSFORMER, COMPRESSOR 1, CIRCUIT A | TI1 | TRANSFORMADOR DE INTENSIDAD, COMPRESOR 1, CIRCUITO A |
| TI2 | CURRENT TRANSFORMER, COMPRESSOR 1, CIRCUIT B | TI2 | TRANSFORMADOR DE INTENSIDAD, COMPRESOR 1, CIRCUITO B |
| Y11 | CAPACITY CONTROL VALVE , COMPRESSOR 1, CIRCUIT A | Y11 | VÁLVULA DE CONTROL DE LA CAPACIDAD, COMPRESOR 1, CIRCUITO A |
| Y12 | CAPACITY CONTROL VALVE , COMPRESSOR 1, CIRCUIT A | Y12 | VÁLVULA DE CONTROL DE LA CAPACIDAD, COMPRESOR 1, CIRCUITO A |
| Y21 | CAPACITY CONTROL VALVE , COMPRESSOR 1, CIRCUIT B | Y21 | VÁLVULA DE CONTROL DE LA CAPACIDAD, COMPRESOR 1, CIRCUITO B |
| Y22 | CAPACITY CONTROL VALVE , COMPRESSOR 1, CIRCUIT B | Y22 | VÁLVULA DE CONTROL DE LA CAPACIDAD, COMPRESOR 1, CIRCUITO B |
| YV71 | OIL VALVE, COMPRESSOR 1, CIRCUIT A | YV71 | VÁLVULA DE ACEITE, COMPRESOR 1, CIRCUITO A |
| YV72 | OIL VALVE, COMPRESSOR 1, CIRCUIT B | YV72 | VÁLVULA DE ACEITE, COMPRESOR 1, CIRCUITO B |

COMPONENT DESIGNATION

DENOMINACIÓN DE LOS COMPONENTES

NAME
NOMBRE

CARRIER

DATE
FECHA

25/01/2018

SHEET
HOJA

3

00DCG008204800

A

SECTION RESERVED FOR ADDITIONAL ON-SITE INFORMATION
 SECCIÓN RESERVADA PARA LA INFORMACIÓN COMPLEMENTARIA QUE SE DEBE INTRODUCIR EN 0

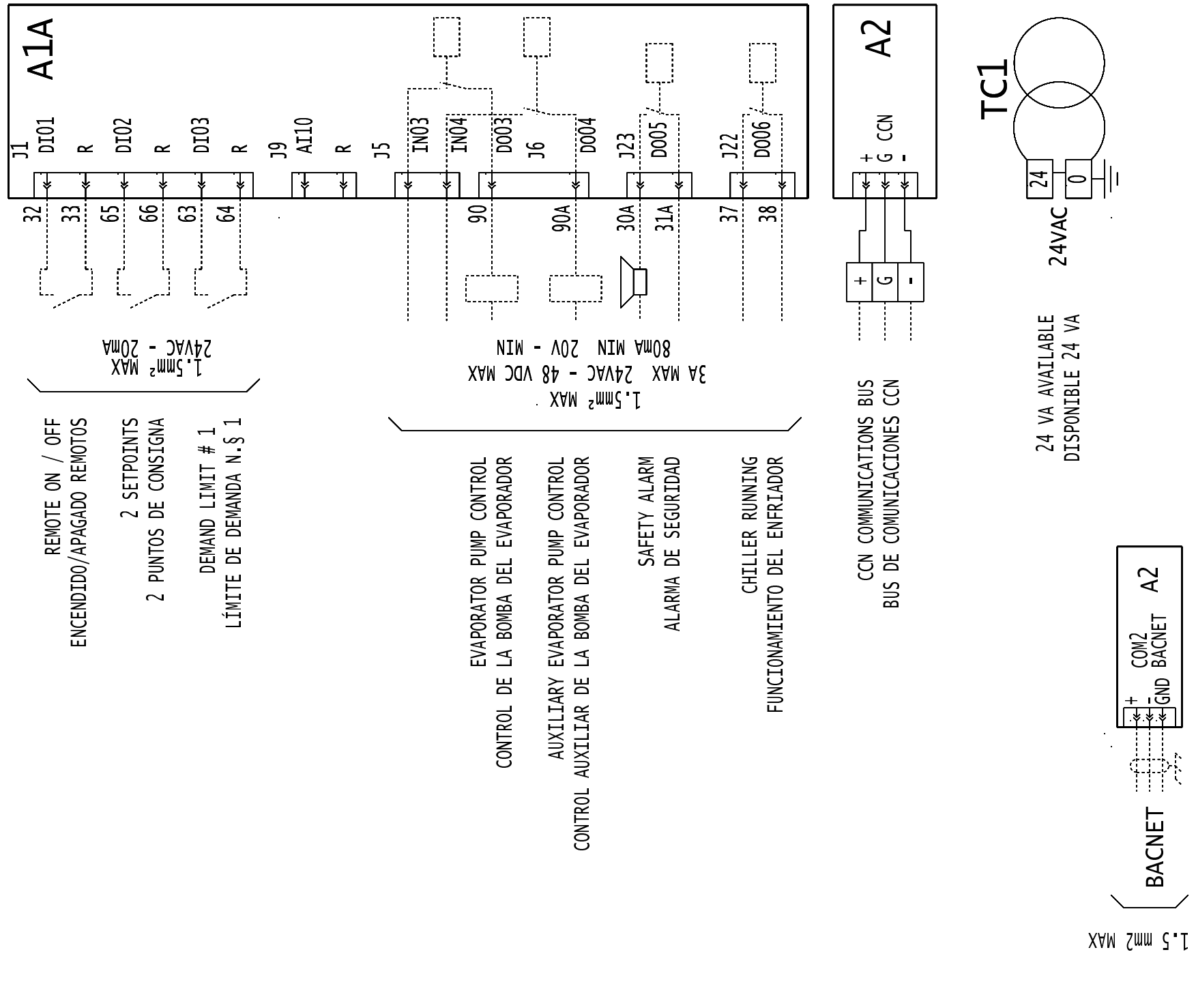

| | | | | | | | | | | | | | | | | | | | | | | | | | | | | | | | | | | | | | | | |
|----|----|----|----|----|----|----|----|----|----|----|----|----|----|----|----|----|----|----|----|----|----|----|----|----|----|----|----|----------------|---------|---------------|---------------|----|----|----|----|----|----|----|----|
| 01 | 02 | 03 | 04 | 05 | 06 | 07 | 08 | 09 | 10 | 11 | 12 | 13 | 14 | 15 | 16 | 17 | 18 | 19 | 20 | 21 | 22 | 23 | 24 | 25 | 26 | 27 | 28 | 29 | 30 | 31 | 32 | 33 | 34 | 35 | 36 | 37 | 38 | 39 | 40 |
| | | | | | | | | | | | | | | | | | | | | | | | | | | | | NAME NOMBRE | CARRIER | DATE FECHA | SHEET HOJA | | | | | | | | |
| | | | | | | | | | | | | | | | | | | | | | | | | | | | | 00DCG008204800 | | 25/01/2018 | 4 | | | | | | | | |
| | | | | | | | | | | | | | | | | | | | | | | | | | | | | | | A | | | | | | | | | |

CONTROL CONNECTIONS
CONEXIONES DE CONTROL

POWER INPUT OF UNIT UNDER MAXIMUM LOAD CONDITIONS
 POTENCIA ABSORBIDA POR LA UNIDAD EN CONDICIONES DE CARGA MÁXIMA

204 kW

MAXIMUM OPERATING CURRENT AT MINIMUM VOLTAGE (360V)
 INTENSIDAD DE FUNCIONAMIENTO MÁXIMA CON LA TENSIÓN MÍNIMA (360V)

354 A

MAXIMUM CURRENT ON START-UP
 INTENSIDAD MÁXIMA DE ARRANQUE

505 A

CURRENT DRAWN AT NOMINAL CONDITIONS (400V)
 INTENSIDAD NOMINAL DE FUNCIONAMIENTO (400V)

260 A

MAXIMUM OPERATING CURRENT AT NOMINAL VOLTAGE (400V)
 INTENSIDAD DE FUNCIONAMIENTO MÁXIMA A LA TENSIÓN NOMINAL (400V)

331 A

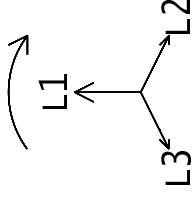

IMPERATIVE : RESPECT THE CORRECT PHASE CONNECTIONS
 IMPERATIVO: RESPETAR LA CONEXIÓN DE LAS FASES CORRECTA

3~50Hz 400V

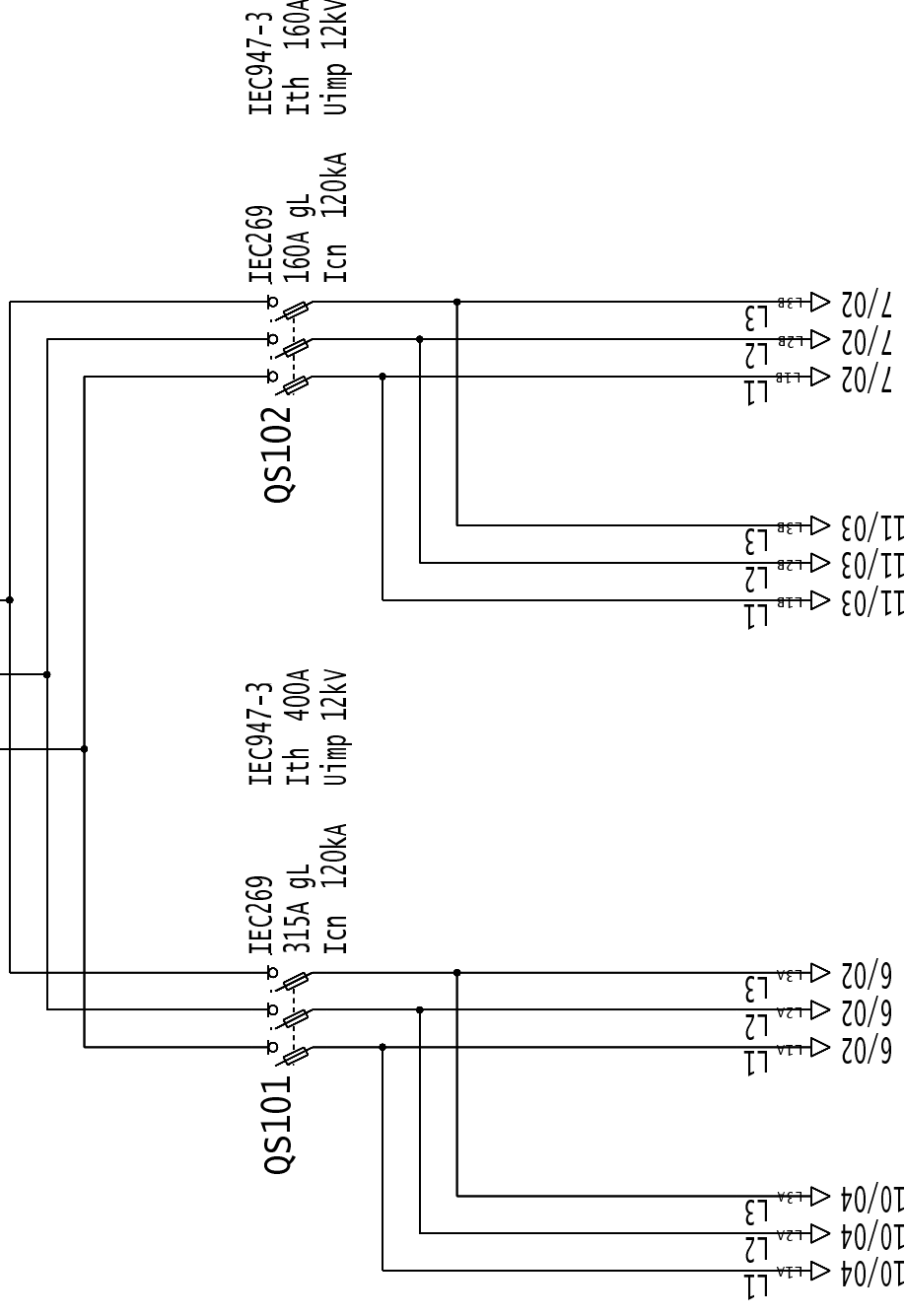

| | | | | | | | | | | | | | | | | | | | | | | | | | | | | | | | | | | | | | | | |
|----|----|----|----|----|----|----|----|----|----|----|----|----|----|----|----|----|----|----|----|----|----|----|----|----|----|----|----|----|----|----|----|----|----|----|----|----|----|----|----|
| 01 | 02 | 03 | 04 | 05 | 06 | 07 | 08 | 09 | 10 | 11 | 12 | 13 | 14 | 15 | 16 | 17 | 18 | 19 | 20 | 21 | 22 | 23 | 24 | 25 | 26 | 27 | 28 | 29 | 30 | 31 | 32 | 33 | 34 | 35 | 36 | 37 | 38 | 39 | 40 |
|----|----|----|----|----|----|----|----|----|----|----|----|----|----|----|----|----|----|----|----|----|----|----|----|----|----|----|----|----|----|----|----|----|----|----|----|----|----|----|----|

POWER SUPPLY
 SUMINISTRO EL CTRICO

NAME / NOMBRE: CARRIER
 DATE / FECHA: 25/01/2018
 SHEET / HOJA: 5

00DCG008204800
 A

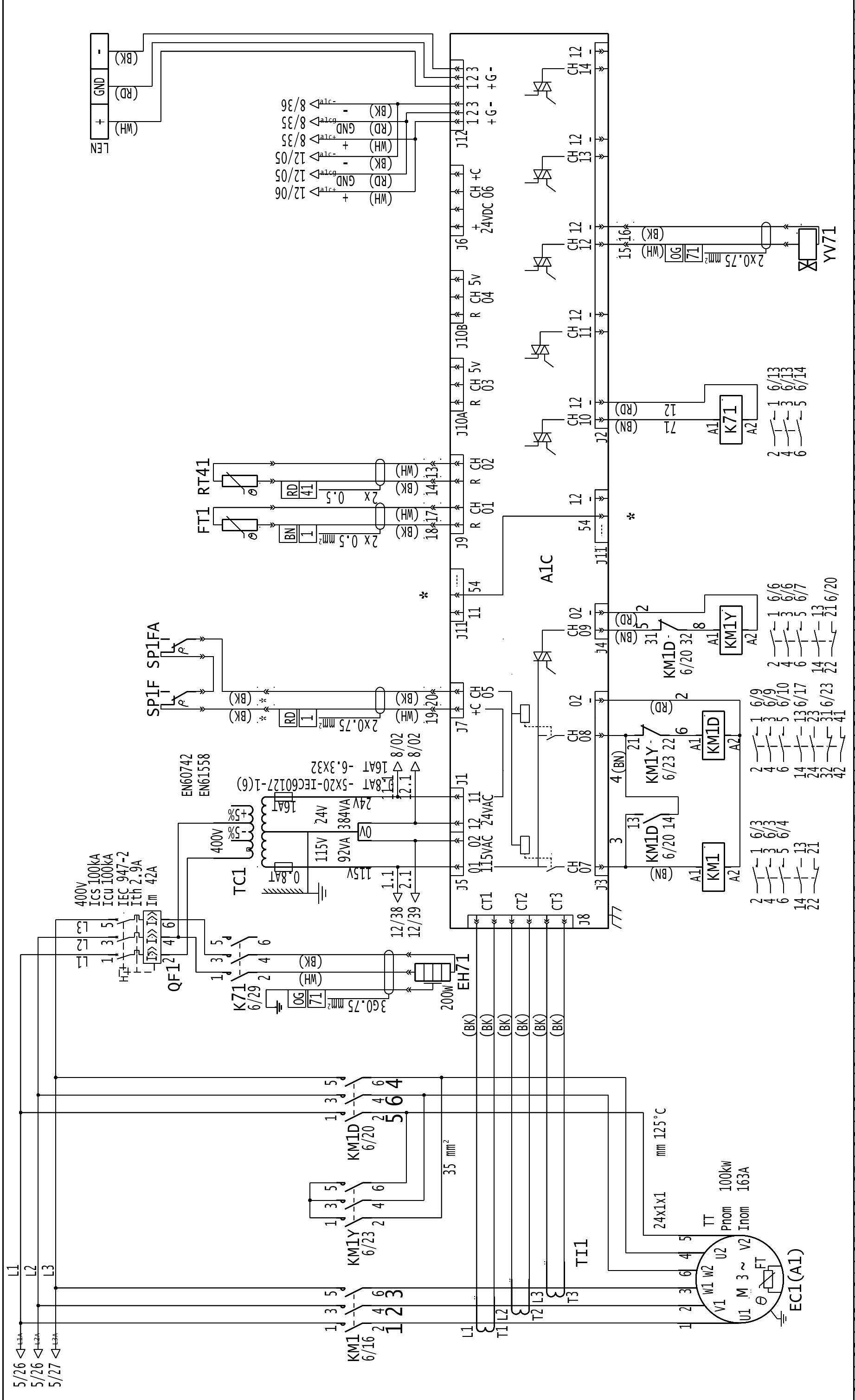

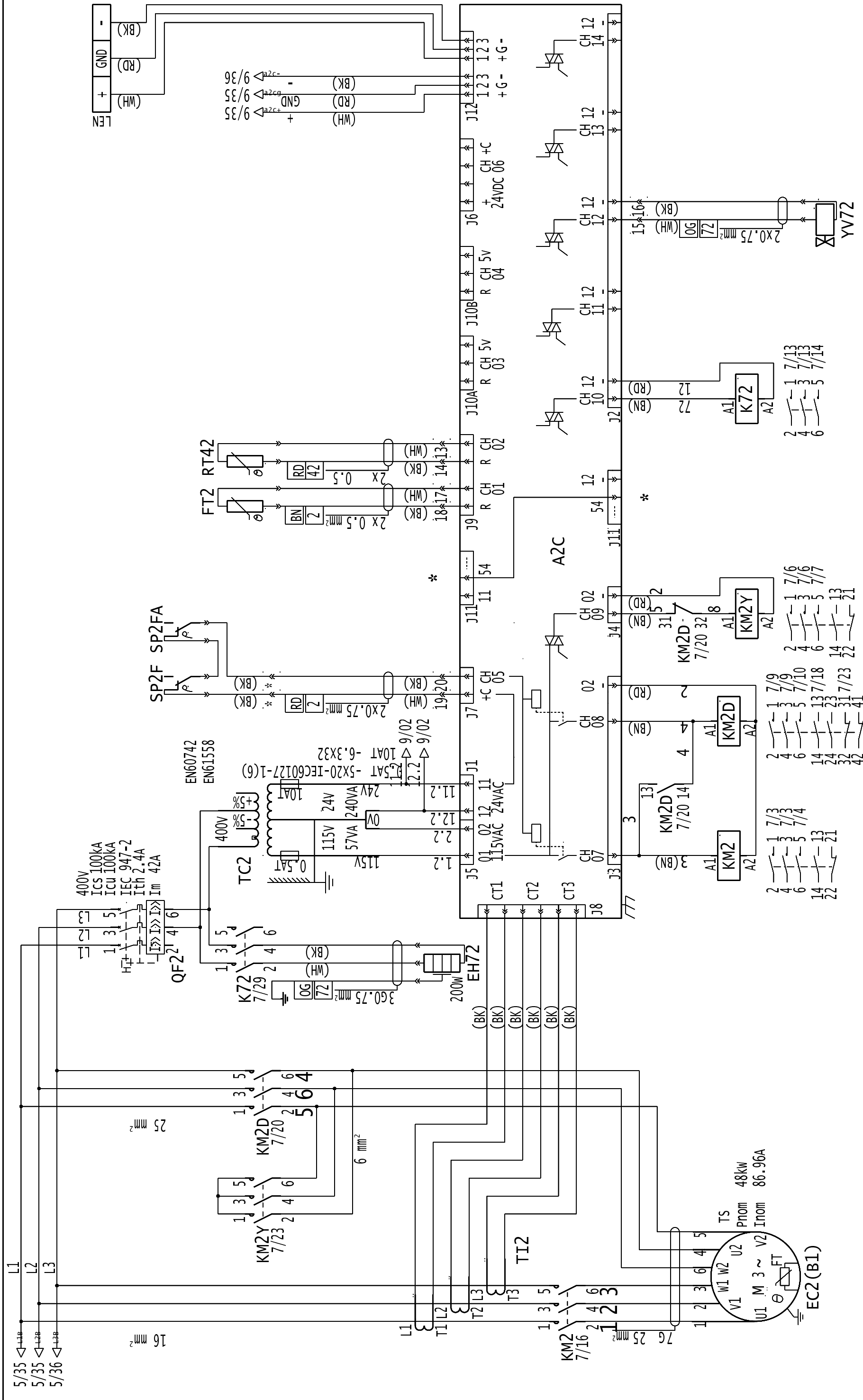

| | | | | | | | | | | | | | | | | | | | | | | | | | | | | | | | | | | | | | | | |
|---|----|----|----|----|----|----|----|----|----|----|----|----|----|----|------------|----|----|----|----|----|----|----|----|----|----|----|----|----|----|----|----|----|----|----|----|----|----|----|----|
| 01 | 02 | 03 | 04 | 05 | 06 | 07 | 08 | 09 | 10 | 11 | 12 | 13 | 14 | 15 | 16 | 17 | 18 | 19 | 20 | 21 | 22 | 23 | 24 | 25 | 26 | 27 | 28 | 29 | 30 | 31 | 32 | 33 | 34 | 35 | 36 | 37 | 38 | 39 | 40 |
| POWER AND CONTROL CIRCUIT COMPRESSOR 1 CIRCUIT B CIRCUITOS DE CONTROL Y POTENCIA DEL COMPRESOR 1, CIRCUITO B | | | | | | | | | | | | | | | | | | | | | | | | | | | | | | | | | | | | | | | |
| NAME NOMBRE | | | | | | | | | | | | | | | CARRIER | | | | | | | | | | | | | | | | | | | | | | | | |
| DATE FECHA | | | | | | | | | | | | | | | 25/01/2018 | | | | | | | | | | | | | | | | | | | | | | | | |
| SHEET HOJA | | | | | | | | | | | | | | | 7 | | | | | | | | | | | | | | | | | | | | | | | | |
| 00DCG008204800 | | | | | | | | | | | | | | | | | | | | | | | | | | | | | | | | | | | | | | | |
| A | | | | | | | | | | | | | | | | | | | | | | | | | | | | | | | | | | | | | | | |

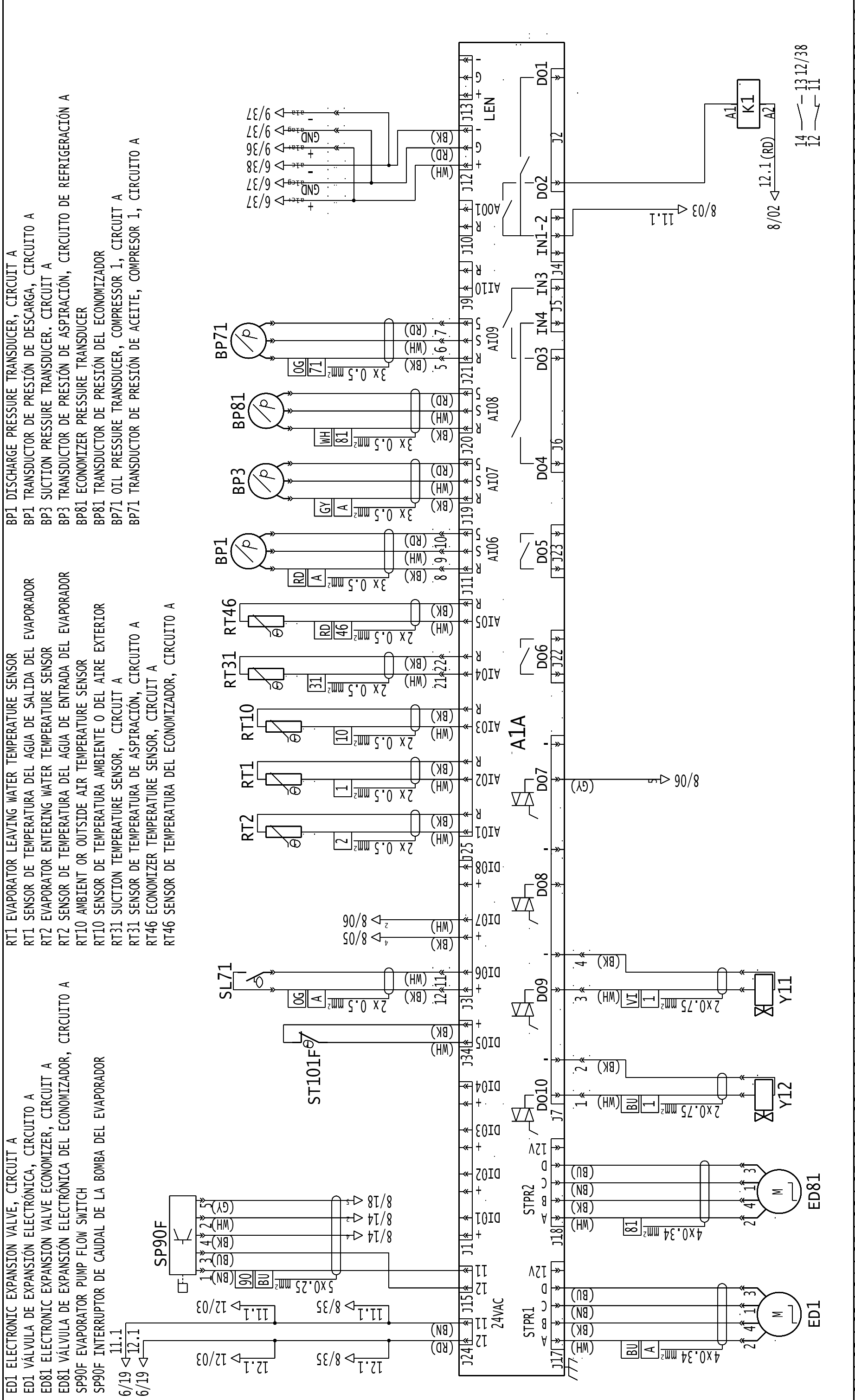

- ED1 ELECTRONIC EXPANSION VALVE, CIRCUIT A
- ED1 VÁLVULA DE EXPANSIÓN ELECTRÓNICA, CIRCUITO A
- ED81 ELECTRONIC EXPANSION VALVE ECONOMIZER, CIRCUIT A
- ED81 VÁLVULA DE EXPANSIÓN ELECTRÓNICA DEL ECONOMIZADOR, CIRCUITO A
- SP90F EVAPORATOR PUMP FLOW SWITCH
- SP90F INTERRUPTOR DE CAUDAL DE LA BOMBA DEL EVAPORADOR
- 6/19 11.1
- 6/19 12.1
- RT1 EVAPORATOR LEAVING WATER TEMPERATURE SENSOR
- RT1 SENSOR DE TEMPERATURA DEL AGUA DE SALIDA DEL EVAPORADOR
- RT2 EVAPORATOR ENTERING WATER TEMPERATURE SENSOR
- RT2 SENSOR DE TEMPERATURA DEL AGUA DE ENTRADA DEL EVAPORADOR
- RT10 AMBIENT OR OUTSIDE AIR TEMPERATURE SENSOR
- RT10 SENSOR DE TEMPERATURA AMBIENTE O DEL AIRE EXTERIOR
- RT31 SUCTION TEMPERATURE SENSOR, CIRCUIT A
- RT31 SENSOR DE TEMPERATURA DE ASPIRACIÓN, CIRCUITO A
- RT46 ECONOMIZER TEMPERATURE SENSOR, CIRCUIT A
- RT46 SENSOR DE TEMPERATURA DEL ECONOMIZADOR, CIRCUITO A
- BP1 DISCHARGE PRESSURE TRANSDUCER, CIRCUIT A
- BP1 TRANSDUCTOR DE PRESIÓN DE DESCARGA, CIRCUITO A
- BP3 SUCTION PRESSURE TRANSDUCER. CIRCUIT A
- BP3 TRANSDUCTOR DE PRESIÓN DE ASPIRACIÓN, CIRCUITO DE REFRIGERACIÓN A
- BP71 ECONOMIZER PRESSURE TRANSDUCER
- BP71 TRANSDUCTOR DE PRESIÓN DEL ECONOMIZADOR
- BP71 OIL PRESSURE TRANSDUCER, COMPRESSOR 1, CIRCUIT A
- BP71 TRANSDUCTOR DE PRESIÓN DE ACEITE, COMPRESOR 1, CIRCUITO A

ED2 ELECTRONIC EXPANSION VALVE, CIRCUIT B
 ED2 VALVULA DE EXPANSIÓN ELECTRÓNICA, CIRCUITO B
 ED82 ELECTRONIC EXPANSION VALVE ECONOMIZER, CIRCUIT B
 ED82 VÁLVULA DE EXPANSIÓN ELECTRÓNICA DEL ECONOMIZADOR, CIRCUITO B

RT32 SUCTION TEMPERATURE SENSOR, CIRCUIT B
 RT32 SENSOR DE TEMPERATURA DE ASPIRACIÓN, CIRCUITO B
 RT47 ECONOMIZER TEMPERATURE SENSOR, CIRCUIT B
 RT47 SENSOR DE TEMPERATURA DEL ECONOMIZADOR, CIRCUITO B

BP2 DISCHARGE PRESSURE TRANSDUCER, CIRCUIT B
 BP2 TRANSDUCTOR DE PRESIÓN DE DESCARGA, CIRCUITO B
 BP4 SUCTION PRESSURE TRANSDUCER, CIRCUIT B
 BP4 TRANSDUCTOR DE PRESIÓN DE ASPIRACIÓN, CIRCUITO DE REFRIGERACIÓN B
 BP82 ECONOMIZER PRESSURE TRANSDUCER
 BP82 TRANSDUCTOR DE PRESIÓN DEL ECONOMIZADOR
 BP72 OIL PRESSURE TRANSDUCER, COMPRESSOR 1, CIRCUIT B
 BP72 TRANSDUCTOR DE PRESIÓN DE ACEITE, COMPRESOR 1, CIRCUITO B

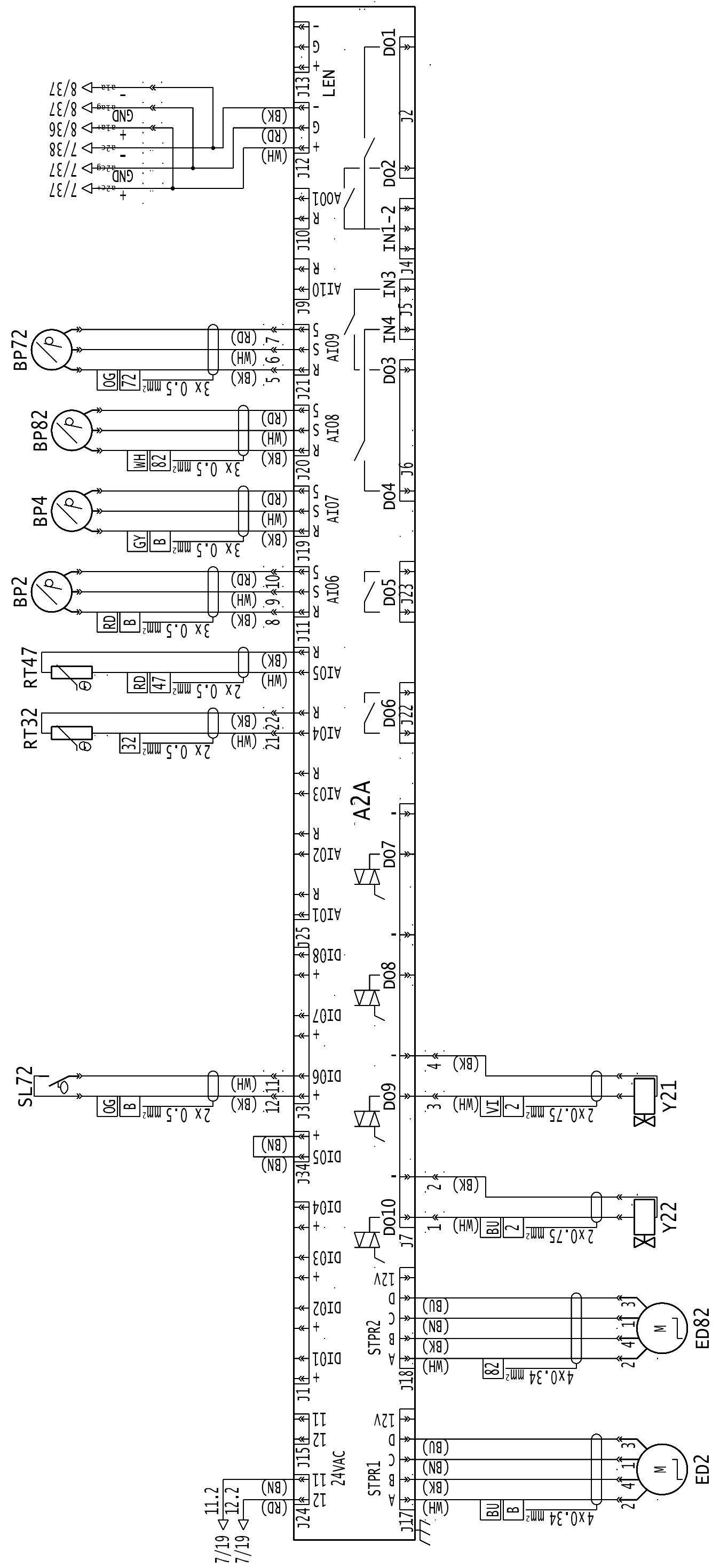

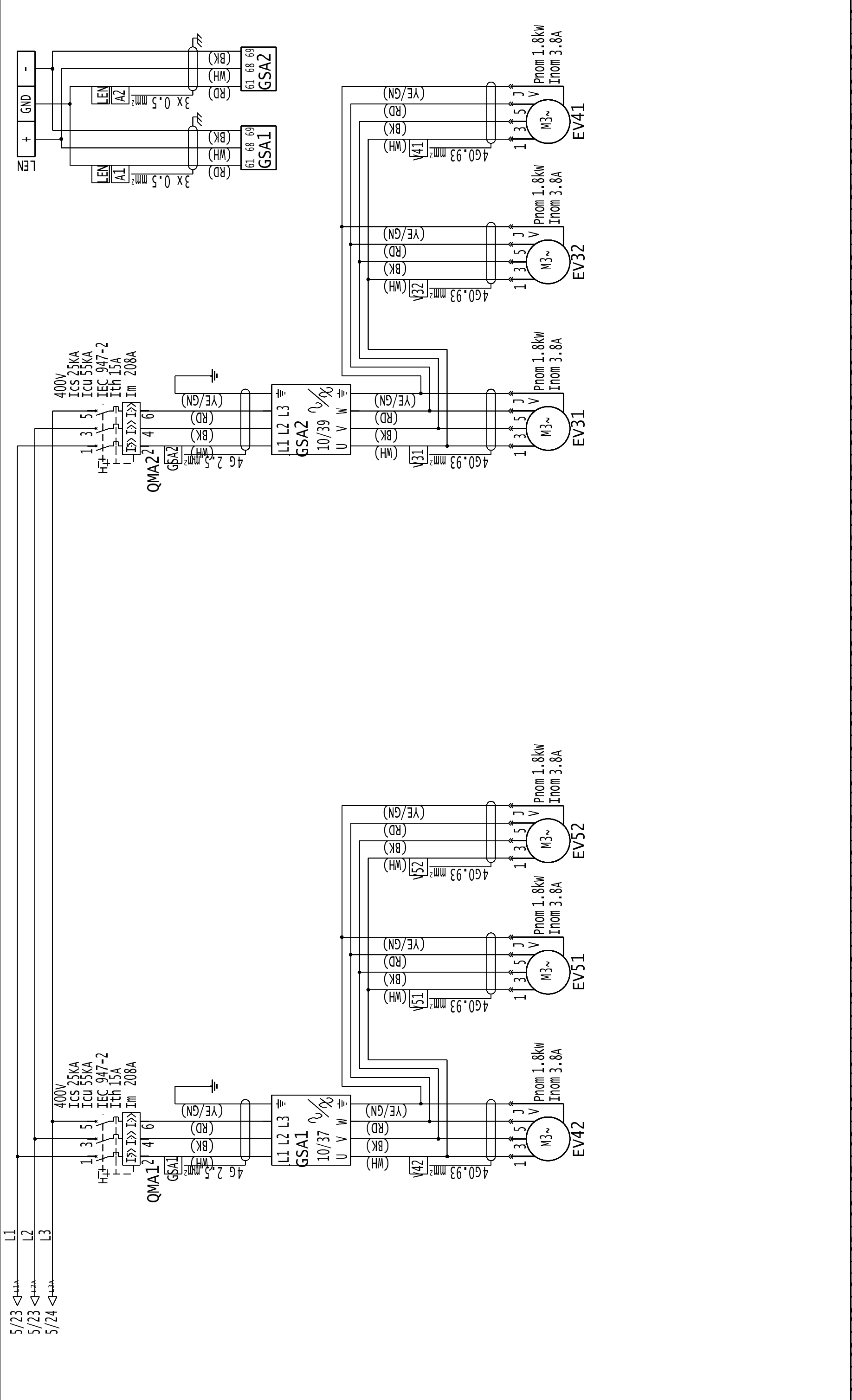

| | | | | | | | | | | | | | | | | | | | | | | | | | | | | | | | | | | | | | | | |
|--|----|----|----|----------|----|----|----|----|----|----|----|----|----|----|----|----|----|----|----|----|----|----|----|----|----|----|----|----|----|----|----|----|-----------------------|---------|---------------|---------------|----|----|----|
| 01 | 02 | 03 | 04 | 05 | 06 | 07 | 08 | 09 | 10 | 11 | 12 | 13 | 14 | 15 | 16 | 17 | 18 | 19 | 20 | 21 | 22 | 23 | 24 | 25 | 26 | 27 | 28 | 29 | 30 | 31 | 32 | 33 | 34 | 35 | 36 | 37 | 38 | 39 | 40 |
| CONDENSER FAN POWER AND CONTROL CIRCUIT A CIRCUITOS DE CONTROL Y ALIMENTACIÓN ELCTRICA DEL VENTILADOR DEL CONDENSADOR, CIRCUITO A | | | | | | | | | | | | | | | | | | | | | | | | | | | | | | | | | NAME NOMBRE | CARRIER | DATE FECHA | SHEET HOJA | | | |
| | | | | | | | | | | | | | | | | | | | | | | | | | | | | | | | | | 00DCG008204800 | | | | | | |
| | | | | | | | | | | | | | | | | | | | | | | | | | | | | | | | | | 10 | | | | | | |
| | | | | A | | | | | | | | | | | | | | | | | | | | | | | | | | | | | | | | | | | |

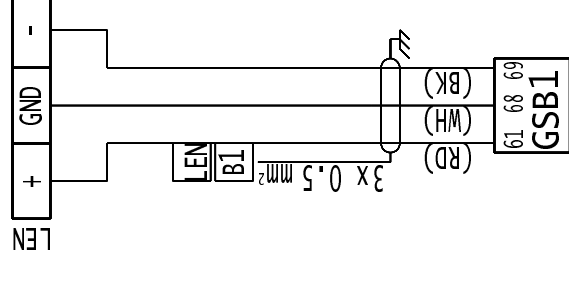
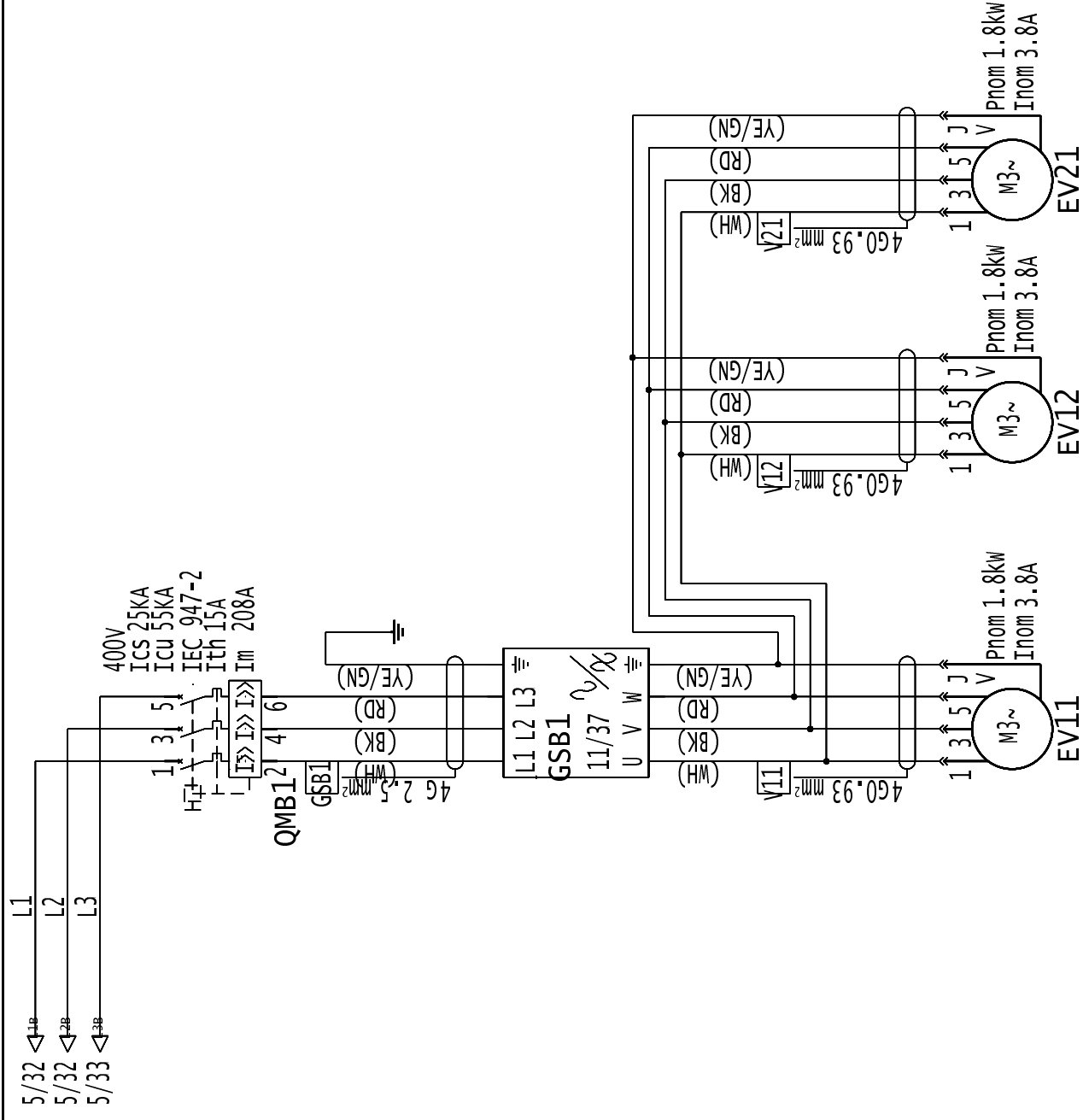

01 02 03 04 05 06 07 08 09 10 11 12 13 14 15 16 17 18 19 20 21 22 23 24 25 26 27 28 29 30 31 32 33 34 35 36 37 38 39 40

CONDENSER FAN POWER AND CONTROL CIRCUIT B
CIRCUITOS DE CONTROL Y ALIMENTACIÓN EL CTRICA DEL VENTILADOR DEL CONDENSADOR, CIRCUITO B

NAME
NOMBRE

CARRIER

00DCG008204800

DATE
FECHA

25/01/2018

SHEET
HOJA

11

A

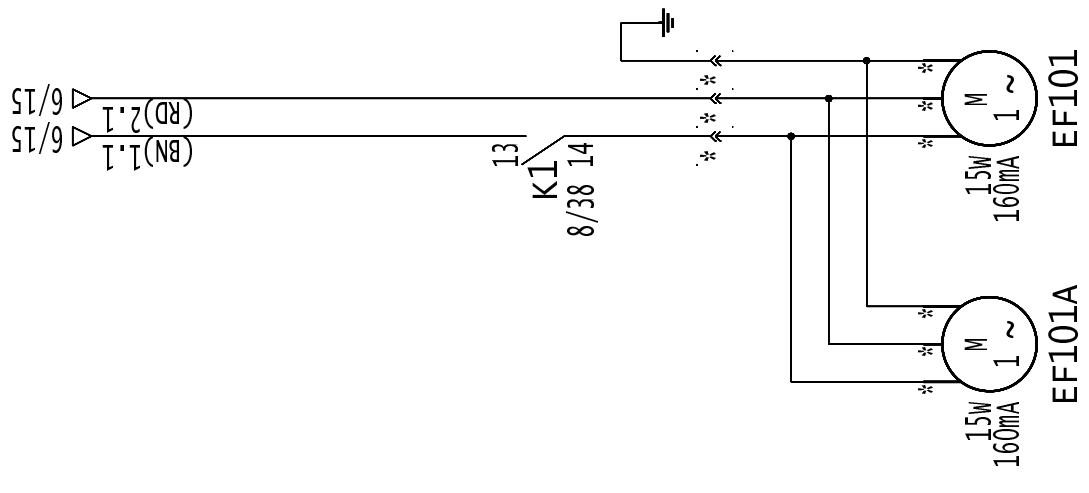
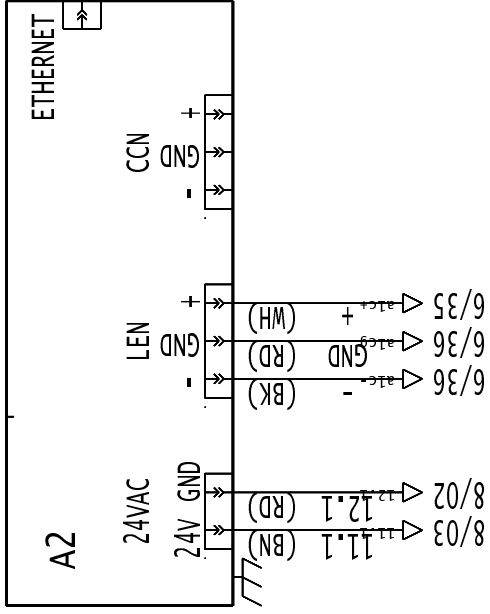

| | | | | | | | | | | | | | | | | | | | | | | | | | | | | | | | | | | | | | | | |
|-----------------------|----|----|----|----|----|----|----|----|----|----|----|----|----|----|----|----|----|----|----|----|----|----|----|----|----|----|----|----|----|--------|---------|------------|-------|----|----|----|----|----|----|
| 01 | 02 | 03 | 04 | 05 | 06 | 07 | 08 | 09 | 10 | 11 | 12 | 13 | 14 | 15 | 16 | 17 | 18 | 19 | 20 | 21 | 22 | 23 | 24 | 25 | 26 | 27 | 28 | 29 | 30 | 31 | 32 | 33 | 34 | 35 | 36 | 37 | 38 | 39 | 40 |
| CONTROL WIRING | | | | | | | | | | | | | | | | | | | | | | | | | | | | | | NAME | CARRIER | DATE | SHEET | | | | | | |
| CONTROL | | | | | | | | | | | | | | | | | | | | | | | | | | | | | | NOMBRE | | FECHA | HOJA | | | | | | |
| 00DCG008204800 | | | | | | | | | | | | | | | | | | | | | | | | | | | | | | | | 25/01/2018 | 12 | | | | | | |
| A | | | | | | | | | | | | | | | | | | | | | | | | | | | | | | | | | | | | | | | |

INSIDE THE ELECTRICAL BOX (UNLESS OTHERWISE SPECIFIED): ALL POWER AND SUPPLY WIRES ARE BLACK.
 GROUND WIRES 2 AND 12 ARE RED.
 THE COMMUNICATION BUS WIRES ARE WHITE, BLACK AND RED.
 ALL OTHER WIRES ARE BROWN.
 THE CONTROL WIRING IS 0.93 MM2, AWG 18 HO5VK QUALITY 105 DEGREES WITH CORE, UNLESS OTHERWISE SPECIFIED.

DENTRO DEL CUADRO EL CTIRICO (A MENOS QUE SE ESPECIFIQUE LO CONTRARIO): TODOS LOS CABLES DE ALIMENTACIÓN SON NEGROS.
 LOS CABLES DE TIERRA 2 Y 12 SON ROJOS.
 LOS CABLES DEL BUS DE COMUNICACIONES SON BLANCOS, NEGROS Y ROJOS.
 TODOS LOS DEMÁS CABLES SON MARRONES.
 EL CABLEADO DE CONTROL ES DE 0,93 MM2, SECCION AWG 18, HO5VK, PROTECCION HASTA 105 GRADOS, CON ALMA, MIENTRAS NO SE ESPECIFIQUE OTRA COSA.

STANDARDISED WIRE COLOURING CODE
 BLACK : BK BROWN : BN
 BLUE : BU GREEN : GN
 GREY : GY AMBER : OG
 RED : RD VIOLET : VI
 WHITE : WH YELLOW : YE

OUTSIDE THE ELECTRICAL BOX (UNLESS OTHERWISE SPECIFIED) CONTROL AND SENSOR MULTI-CONDUCTOR CABLES ARE QUALITY 105 DEGREES WITH CORE, TYPE 05WVF FOR OUTDOOR USE

CÓDIGO NORMALIZADO DE COLORES DE LOS CABLES
 NEGRO: BK MARRÓN: BN
 AZUL: BU VERDE: GN
 GRIS: GY NARANJA: OG
 ROJO: RD VIOLETA: VI
 BLANCO: WH AMARILLO: YE

FUERA DE LA CAJA ELECTRICA (SALVO ESPECIFICACION EN CONTRARIO), LOS CABLES DE VARIOS CONDUCTORES PARA LOS SENSORES Y EL CONTROL TIENEN PROTECCION HASTA 105 GRADOS, TIENEN ALMA Y SON DEL TIPO 05VVF PARA USO A LA INTEMPERIE

| | | | | | | | | | | | | | | | | | | | | | | | | | | | | | | | | | | | | | | | |
|----|----|----|----|----|----|----|----|----|----|----|----|----|----|----|----|----|----|----|----|----|----|----|----|----|----|----|----|----|----|----|----|----|----|----|----|----|----|----|----|
| 01 | 02 | 03 | 04 | 05 | 06 | 07 | 08 | 09 | 10 | 11 | 12 | 13 | 14 | 15 | 16 | 17 | 18 | 19 | 20 | 21 | 22 | 23 | 24 | 25 | 26 | 27 | 28 | 29 | 30 | 31 | 32 | 33 | 34 | 35 | 36 | 37 | 38 | 39 | 40 |
|----|----|----|----|----|----|----|----|----|----|----|----|----|----|----|----|----|----|----|----|----|----|----|----|----|----|----|----|----|----|----|----|----|----|----|----|----|----|----|----|

TERMINAL BLOCK AND NOTES
 BLOQUE DE TERMINALES Y NOTAS

| | | | |
|----------------|---------|---------------|---------------|
| NAME NOMBRE | CARRIER | DATE FECHA | SHEET HOJA |
|----------------|---------|---------------|---------------|

| | | | |
|----------------|------------|----|---|
| 00DCG008204800 | 25/01/2018 | 13 | A |
|----------------|------------|----|---|

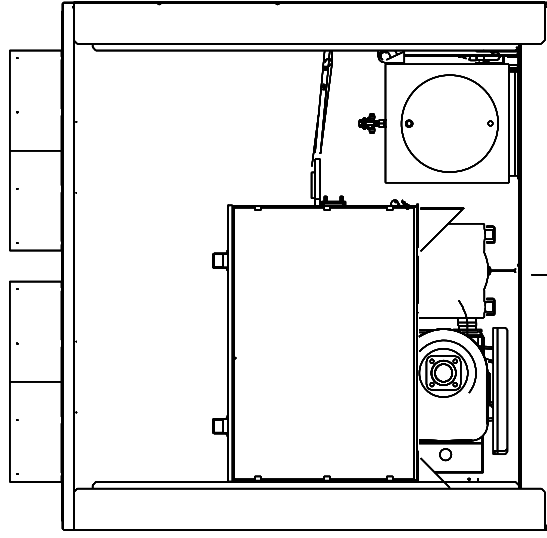

SL71
8/12

SL72
9/12

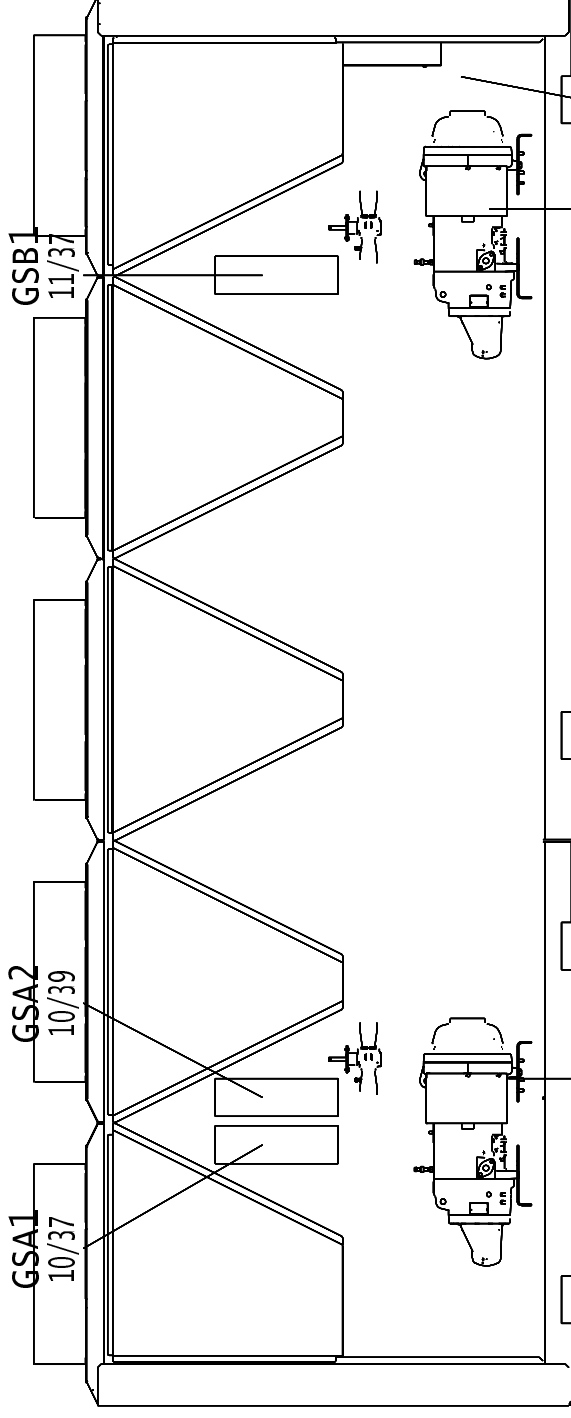

GSA1
10/37

GSA2
10/39

GSB1
11/37

E1(A1)
6/3

E2(B1)
7/3
RT10
8/20

RT1
8/18
RT2
8/17
SP90F
8/4

BP3
8/26

RT46 BP81
8/23 8/28

ED81 ED82
8/6 9/6

ED1
8/2

ED2 BP82
9/2 9/28

RT47
9/23

EH71
6/13

BP1
8/24

YV71
6/34

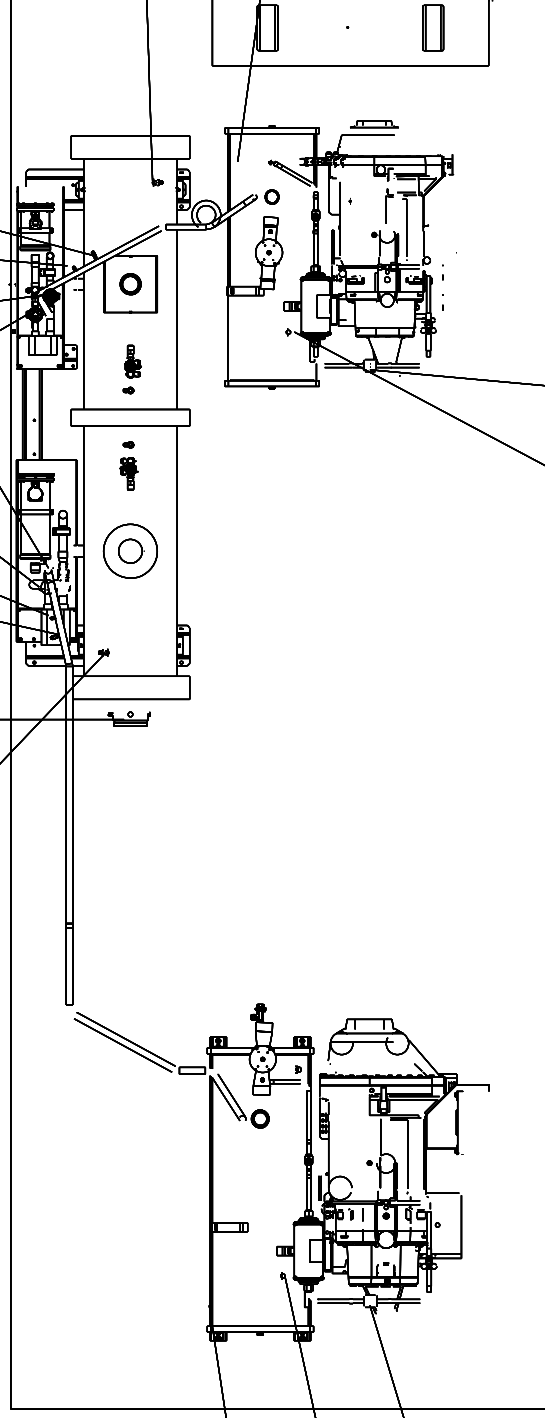

BP2 YV72
9/24 7/34

BP4
9/26

EH72
7/13

01 02 03 04 05 06 07 08 09 10 11 12 13 14 15 16 17 18 19 20 21 22 23 24 25 26 27 28 29 30 31 32 33 34 35 36 37 38 39 40

SITING
UBICACIÓN

NAME
NOMBRE

CARRIER

DATE
FECHA 25/01/2018

SHEET
HOJA 14

00DCG008204800

A

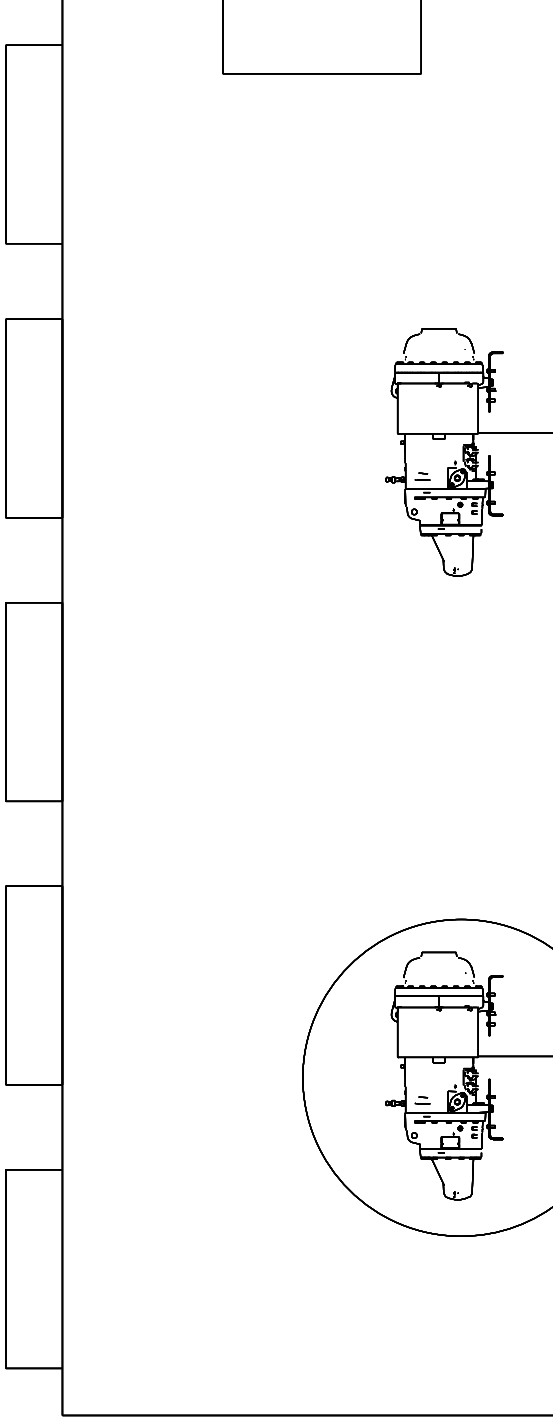

BP71 RT31
8/30 8/21
SP1F Y11
6/20 8/12
RT41 Y12
6/27 8/9
SP1FA FT1
6/22 6/26

BP72 RT32
9/30 9/21
SP2F Y21
7/20 9/12
RT42 Y22
7/27 9/9
SP2FA FT2
7/22 7/26

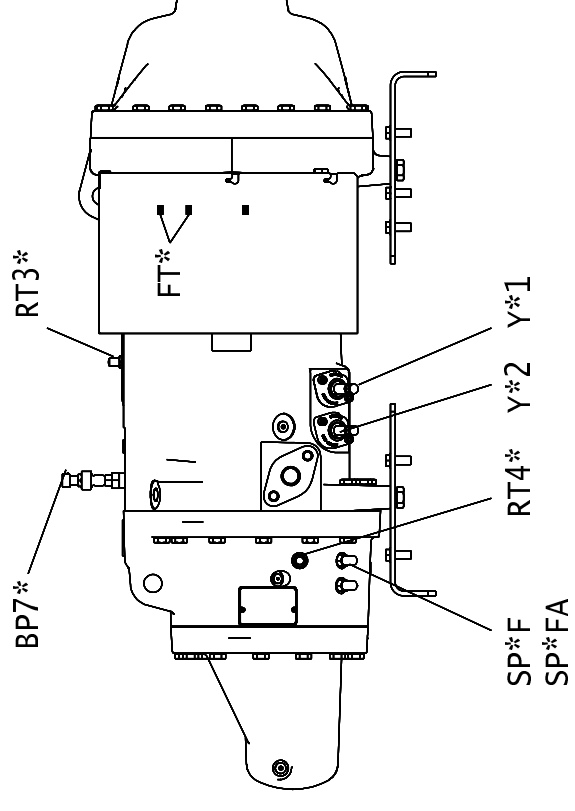
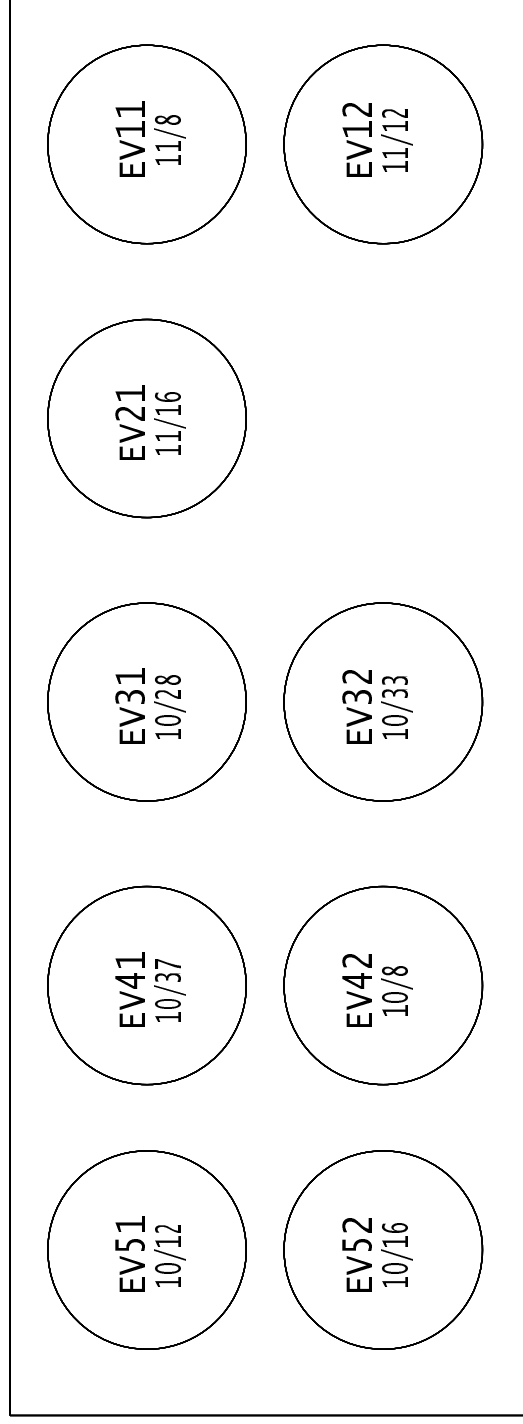

01 02 03 04 05 06 07 08 09 10 11 12 13 14 15 16 17 18 19 20 21 22 23 24 25 26 27 28 29 30 31 32 33 34 35 36 37 38 39 40

SITING
UBICACIÓN

NAME
NOMBRE

CARRIER

DATE
FECHA

SHEET
HOJA

00DCG008204800

15

A

QMA1 10/8
QMA2 10/28
QMB1 11/8

K1 8/38

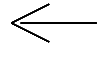
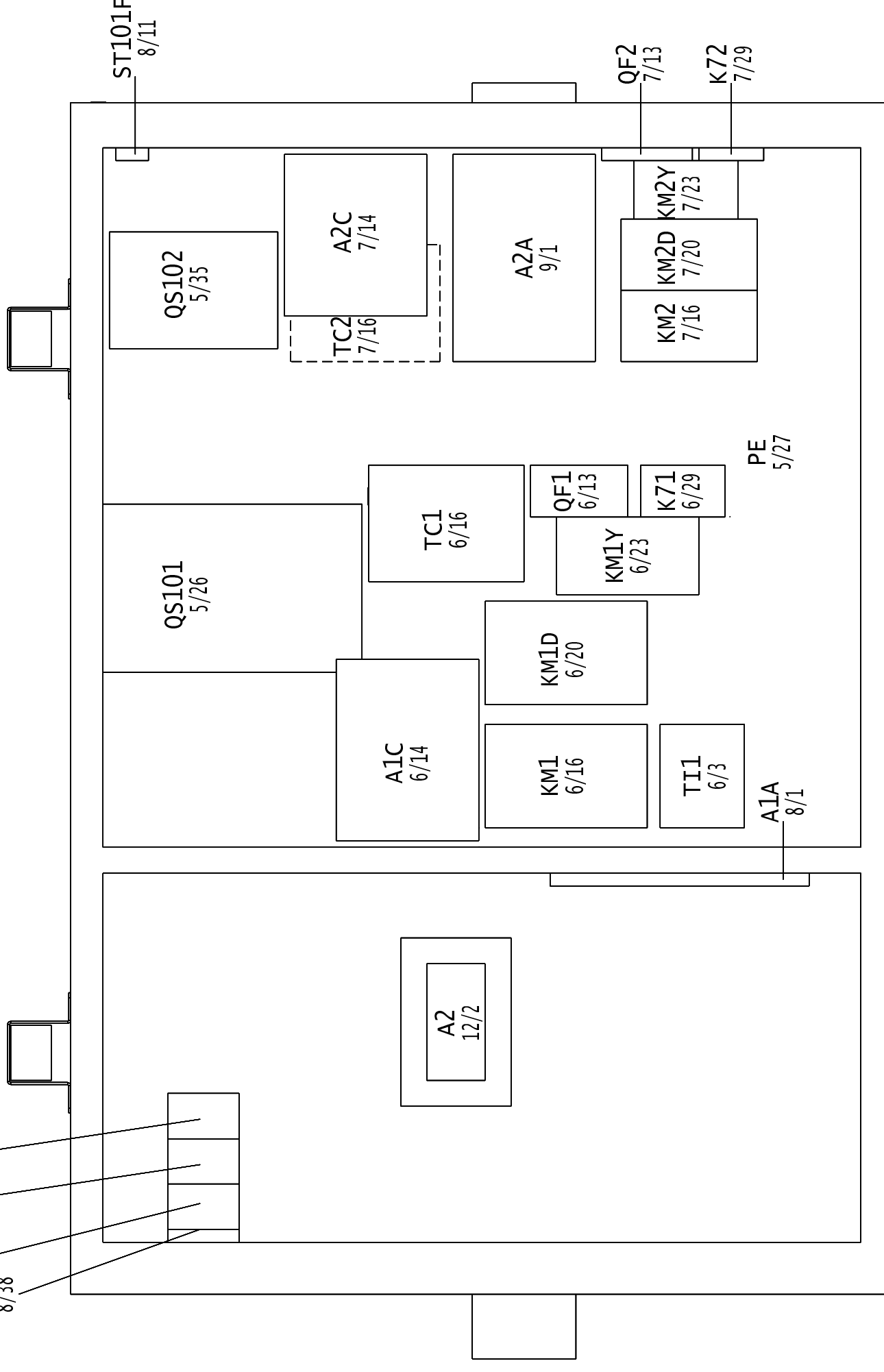

EF101
12/38

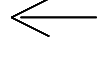

EF101A
12/35

| | | | | | | | | | | | | | | | | | | | | | | | | | | | | | | | | | | | | | | | |
|-----------|----|----|----|----|----|----|----|----|----|----|----|----|----|----|----|----|----|----|----|----|----|----|----|----|----|----|----|----|----|----------------|---------|------------|-------|----|----|----|----|----|----|
| 01 | 02 | 03 | 04 | 05 | 06 | 07 | 08 | 09 | 10 | 11 | 12 | 13 | 14 | 15 | 16 | 17 | 18 | 19 | 20 | 21 | 22 | 23 | 24 | 25 | 26 | 27 | 28 | 29 | 30 | 31 | 32 | 33 | 34 | 35 | 36 | 37 | 38 | 39 | 40 |
| SITING | | | | | | | | | | | | | | | | | | | | | | | | | | | | | | NAME | CARRIER | DATE | SHEET | | | | | | |
| UBICACIÓN | | | | | | | | | | | | | | | | | | | | | | | | | | | | | | NOMBRE | | 25/01/2018 | HOJA | | | | | | |
| | | | | | | | | | | | | | | | | | | | | | | | | | | | | | | 00DCG008204800 | | | | 16 | | A | | | |